

Outbuildings

All of the Individual Buildings you will see below are “Resurrection-Ready”!

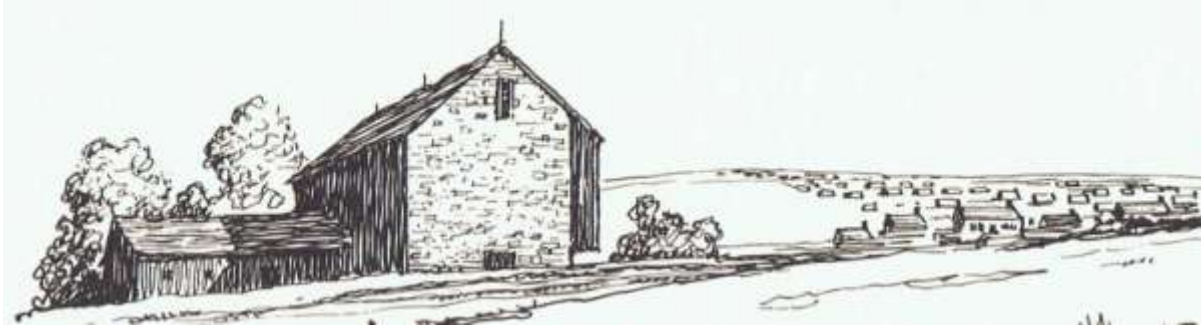

Progress Encroaching on Magnificent Buildings: Welcome the story of Glorious Resurrection!

The buildings you see here are ready to be reconstructed wherever you say. They’re all yours! They are here because, yes, they have been threatened by the bulldozer. They have been either physically removed to *temporary safety* by an AGN Network Professional or are still standing under their watchful eye, “under contract in the field”, in hopes of adoption. They are all *temporarily* “saved”. None of them are *really* saved until they are adopted by a citizen-steward or a designer to be reconstructed into a new future, in a new location.

The Buildings you see here are “Resurrection Ready”. They get documented, numbered and tagged, meticulously and methodically deconstructed, whisked away to safety, repaired and placed in watchful storage by trained Network Professionals. Some have been freshly rescued. Some are still standing. Some have been lingering in storage for years. Storage tends to cost insistent dollars and is not to be viewed as a perpetual solution. The AGN Network Professionals are footing those bills for us right now.

But we have an idea....(continued at the bottom of the page)

Let’s look at buildings now.



A little bit about Outbuildings



Outbuildings are a bit scarce. And we need them and we want them.

What *happened*?

Didn’t folks in the past want them? Yes they did. We want them and need them today.

Life changed and technology changed and created new uses for our existing buildings.

So, again, what *happened*?

It varied from state to state, but in around the 1920s, many states began to tax properties based on their buildings, including their outbuildings. When tough economic times came, they often impacted rural areas heavily; outbuildings were intentionally destroyed in order for farmers to be able to save tax money and thus save their properties. An authentic outbuilding that *has* survived is almost always currently being put to essential purpose by the property owner for the very same reasons that you so importantly want one. They are hard to come by for reconstruction purposes but that’s okay. The best possible scenario is for the building to stay in its original location anyway. That’s the best stewardship of all. But there are some around....

Sometimes, even today, because of taxes and the march of progress, these buildings suddenly become available. Here you will find them: authentic outbuildings and small barns. We appreciate your stewardship in helping to save them.

If we can’t locate one and you need us to reproduce an authentic building using salvaged antique materials, our artists are particularly experienced in the lore, logistics and fine point details of their original craftsmanship. They have studied these Unique Originals because they have deconstructed and reconstructed authentic buildings many times. They can create a “New Original” for *you* through the same evolving processes that brought these buildings into being in the first place.

Floor Plans that represent sample minimum dimensions for you to play with as you look at Building Frames
 Scroll down to the bottom of the page to see larger versions for details.

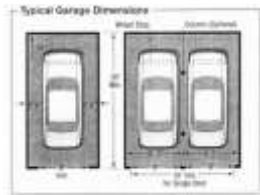

Garage
20' x 24'

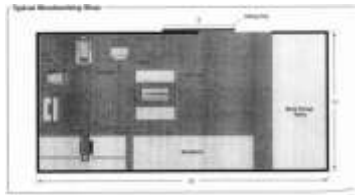

Workshop
12' x 24'



Two Stall Stable +
24' x 36'

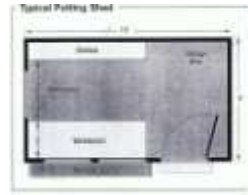

Potting Shed
10' X 6'



Equipment Shed
8' x 10'



Outbuildings



Outhouse with writing on the walls **Sold**



Hand Hewn Chestnut Well House - SOLD

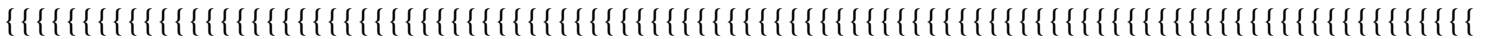

The Berwick Cooper Shop

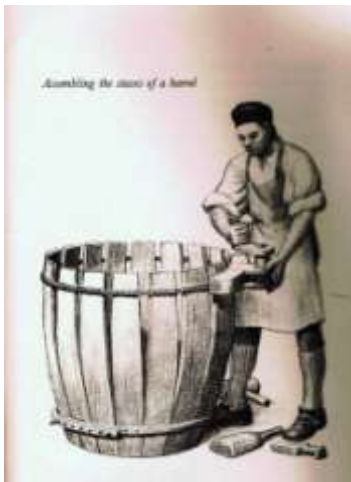



The Berwick Cooper Shop



Circa 1820 Corn Crib



Circa 1820 Corn Crib

12' x 14'

12' x 14'

c. 1820

Hewn Spruce

Enough room for a small loft under the rafters

Siding and Roofing Materials were salvaged



Drive Thru Tractor Barn with Corn Cribs on either side



Drive Thru Tractor Barn with Corn Cribs Drive on either side

24 x26

Poplar siding

16' to peak

5/12 pitch

Oak floor on second floor

Oak frame

Oak rafters

Second floor to peak 11'4"

Second floor knee wall is 41"

Floor to collar ties 7' 6"

There is a front and back door

One corn crib houses the steps to second floor



Milk house



Corn Crib



Corn Crib Reproduced from Salvage



Cantilevered Potting Shed repro



The Bunk House repro



Gazebo, 1890

12'5" across, 5' each side panel, 23' to top of finial
The proper finial is in storage



5 Floor Plans that represent minimum dimensions for you to play with as you look at Building Frames. If you want to see these schematics larger, feel free to email me: jonaharvey@comcast.net

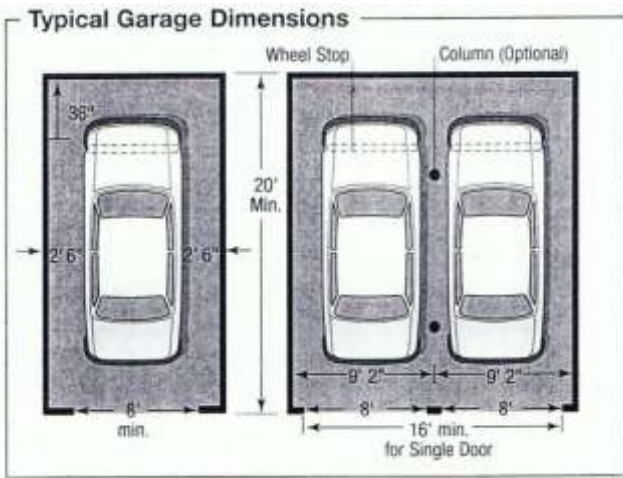

**Garage 20' x 24' minimum for 3 Car Garage,
20' x 12' for 2 Car Garage**

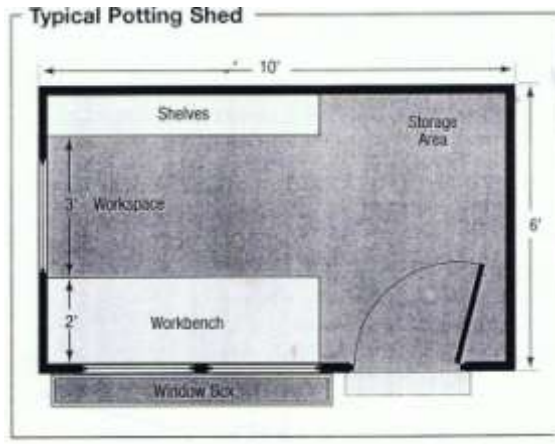

**Potting Shed
10' x 6'**

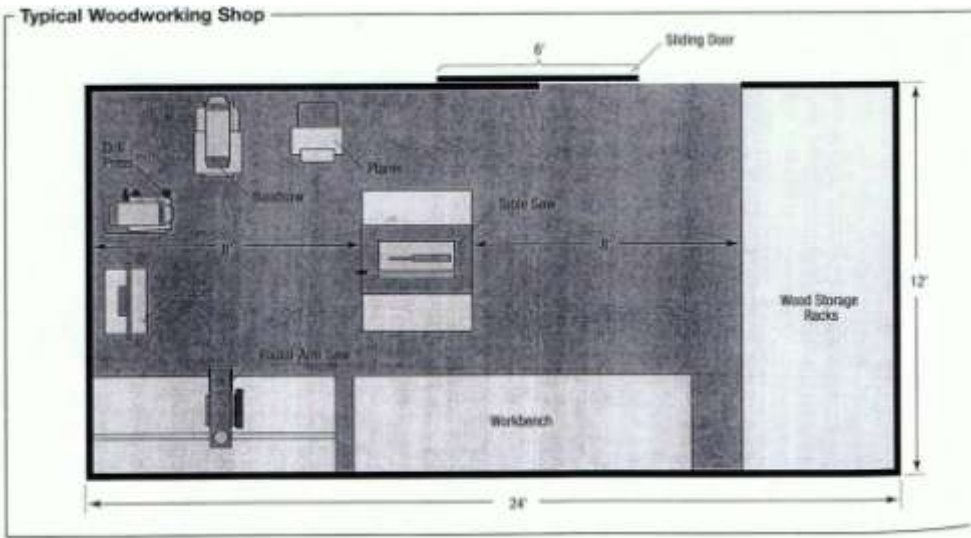

WoodWorking or Hobby Shop 12' x 24'

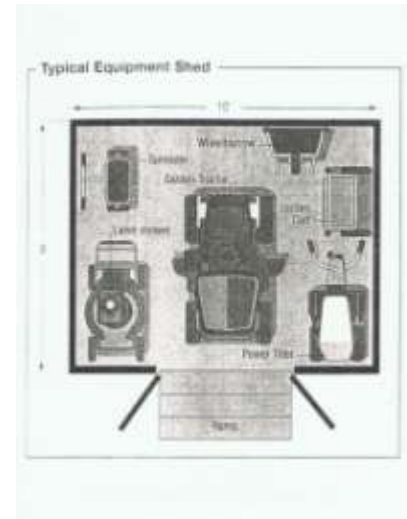

Equipment Shed 8' x 10'

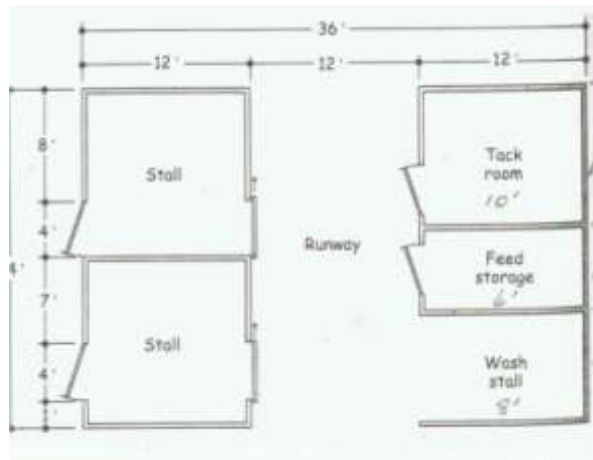

**Two Stall Stable with Tack Room, Wash Stall and Feed Area
24' x 36'**



stand by saying "Ain't it Awful?" That's beneath the Pioneer Spirit! Progress is here to stay and we need to create a pro-active response to it. We can honor our venerable homesteading pioneers with a pioneer homesteading protocol: a Resurrection Explosion. (Reconstruction has been happening since Medieval times. It "ain't that hard")

We can Reshuffle and Relocate these magnificent buildings as an ordinary part of our "New to Look Old" Best Practices to meet the population shifts of modern and future times!

Yes or Yes, America?

For further conceptual reaches on this issue, and some ideas about why it's *not* common practice, consult our News Page and share your ideas! We need 'em!



A Reconstructed Antique Building!

The New Old House!

All the advantages of New and all the Charm of the Genuine Antique!
This is your chance to bring the building into good order for the future!
You are the Steward of this sacred moment!

If you are reconstructing an antique building, you are in the wondrous position of having all the advantages of a brand new home and all the privileges, charm and mystic of an antique building! You lucky duck!

While the antique building is theoretically "open to suggestion" before its reconstruction period, you are in the enviable position of being able to design all and any of the energy saving luxuries and modern living necessities currently in invention into its future. Your due diligence at this point will help to ensure that the building will be beloved well into the future! Thanks!



Click our Catalog Icon:

Back to the Future, Forward to the Future Primitive Whole House Lighting Ambiance

Wire for it now!

What else would you like to arrange for this building's future?



Architectural Global Network

The National "Go To Source"

Jona Harvey

www.GoToAGN.com

610-565-4594 – Office, Yes, we're national!

610-247-1253 - Cell

888-807-1842 - Toll Free

FindIt@GoToAGN.com

AGN is going Global

